



English:

- Torque all screws to the correct value.

Français:

- Torque toutes les vis avec le bonne valeur.

Português:

- Apertar todos os parafusos com o valor correto de torque.

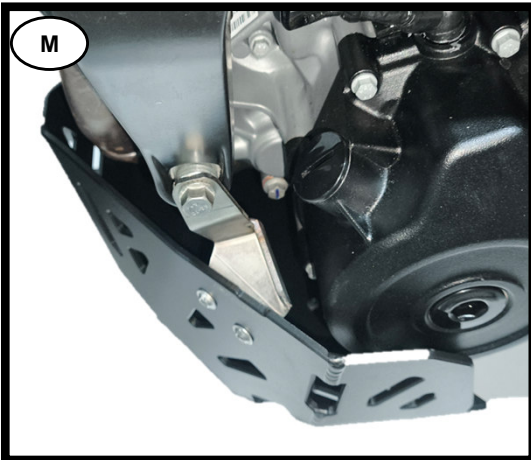

English:

- Torque all screws to the correct value.

Français:

- Torque toutes les vis avec le bonne valeur.

Português:

- Apertar todos os parafusos com o valor correto de torque.

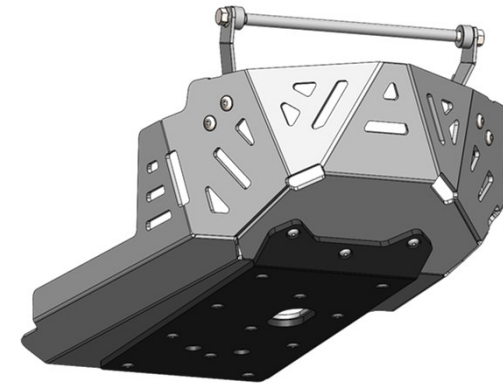

ALUMINUM TRAIL ENGINE GUARD

Ref.: 2AS0900123



Assembly Booklet / Paper collection
Livret de montage / Collecte de papier



Mini Zip Bag / Plastic collection
Mini sac zip / Collecte de plastique



Box / Paper collection
Boîte / Collecte de papier



Carton Separator / Paper collection
Séparateur de cartons / Collecte de papier



Card Header / Paper collection
Carte d'en-tête / Collecte de papier



Plastic Bag Cover / Plastic collection
Couverte de sac en plastique / Collecte de plastique



ASSEMBLY SEQUENCE / INSTRUÇÃO DE MONTAGEM

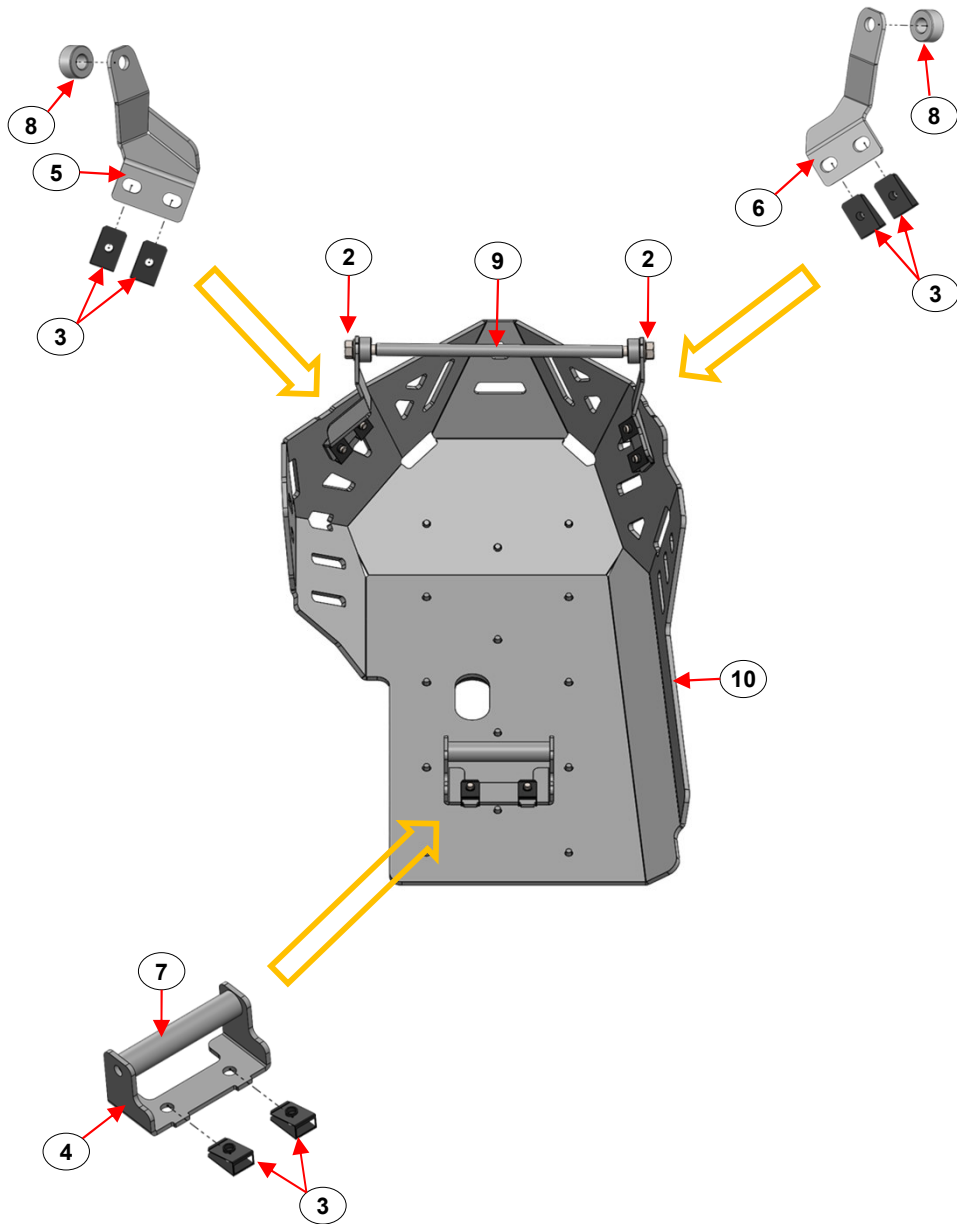

ALUMINUM TRAIL ENGINE GUARD

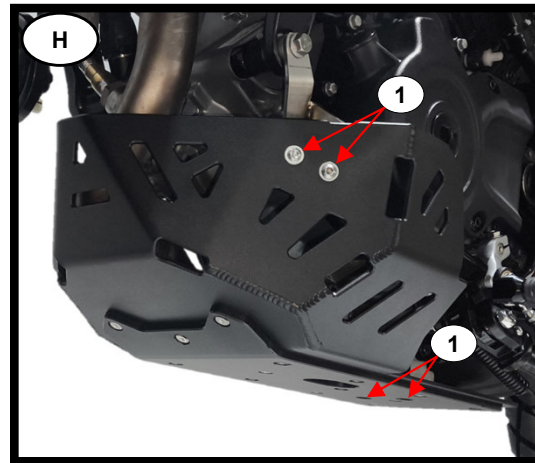

English:

• Mount Engine Guard according to the assembly instruction.

Français:

• Monter la Protection selon les instructions de montage.

Português:

• Montar a Proteção de acordo com a instrução de montagem.

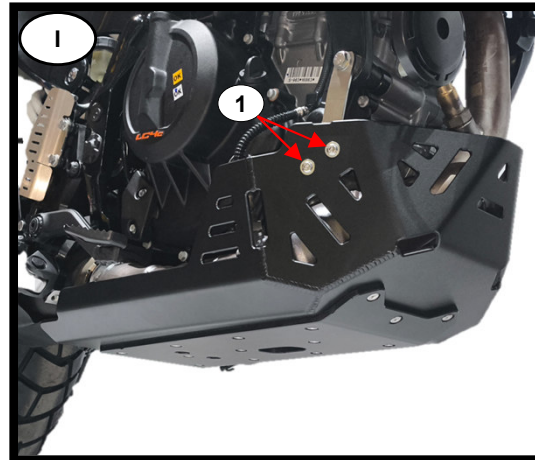

English:

• Mount Engine Guard according to the assembly instruction.

Français:

• Monter la Protection selon les instructions de montage.

Português:

• Montar a Proteção de acordo com a instrução de montagem.

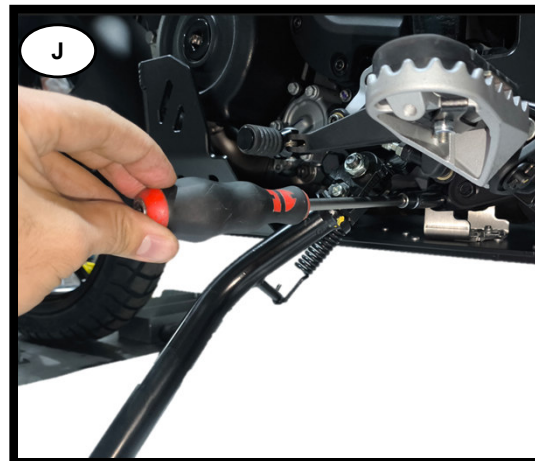

English:

• Torque all screws to the correct value.

Français:

• Torque toutes les vis avec le bonne valeur.

Português:

• Apertar todos os parafusos com o valor correto de torque.

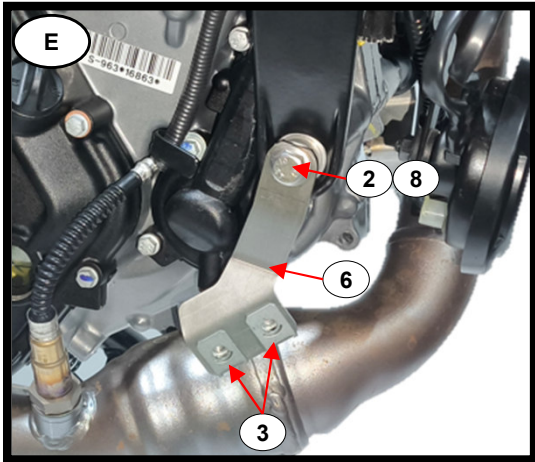

English:

• Mount item N°6 (Stainless Steel Clamp – x1) according to the assembly instruction.
▶ ATTENTION: do not tighten screw.

Français:

• Monter l'item N°6 (Fixation Inox – x1) selon les instructions de montage.

▶ ATTENTION: ne pas serrer le vis..

Português:

• Montar o item N°6 (Fixação Inox – x1) de acordo com a instrução de montagem.

▶ ATENÇÃO: não dar aperto ao parafuso.

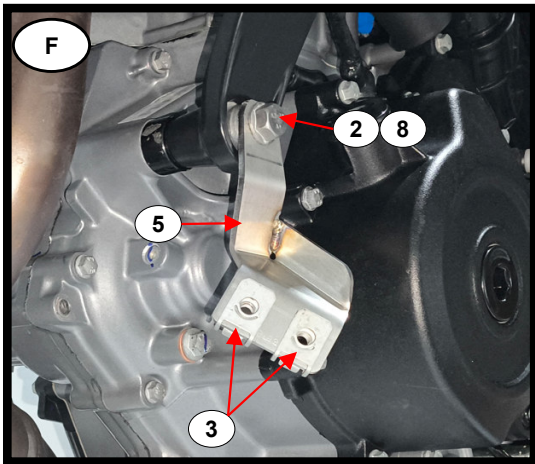

English:

• Mount item N°5 (Stainless Steel Clamp – x1) according to the assembly instruction.
▶ ATTENTION: do not tighten screw.

Français:

• Monter l'item N°5 (Fixation Inox – x1) selon les instructions de montage.

▶ ATTENTION: ne pas serrer le vis..

Português:

• Montar o item N°5 (Fixação Inox – x1) de acordo com a instrução de montagem.

▶ ATENÇÃO: não dar aperto ao parafuso.

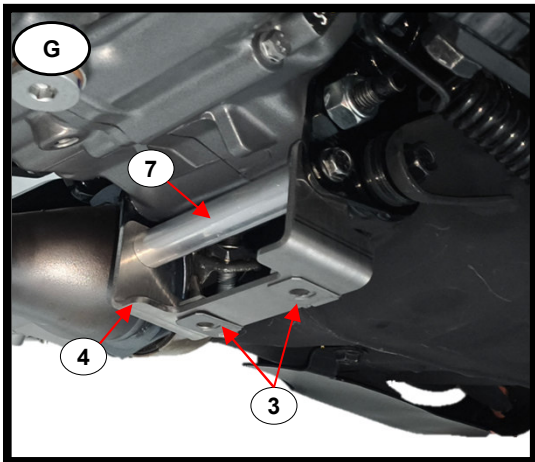

English:

• Mount item N°5 (Stainless Steel Clamp – x1) according to the assembly instruction.
▶ ATTENTION: apply the OEM screw - do not tighten.

Français:

• Monter l'item N°5 (Fixation Inox – x1) selon les instructions de montage.

▶ ATTENTION: appliquez le vis OEM - ne la serrez pas.

Português:

• Montar o item N°5 (Fixação Inox – x1) de acordo com a intrução de montagem.

▶ ATENÇÃO: aplicar parafusos OEM – não dar aperto.

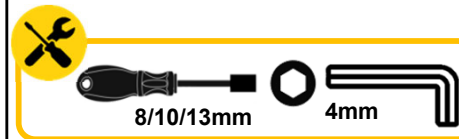
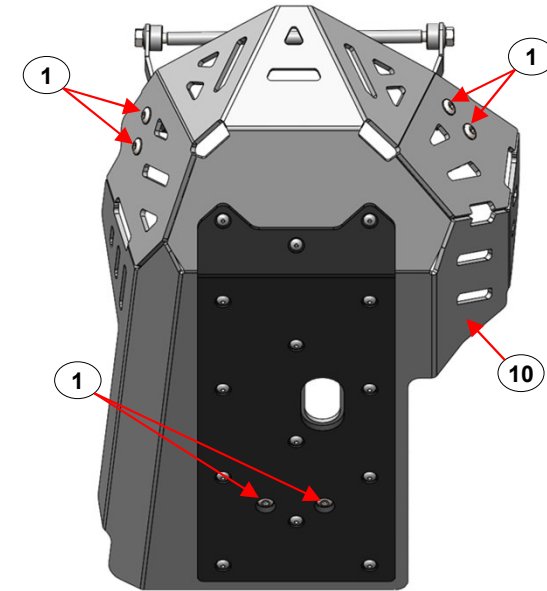

N.m	STAINLESS	
	STEEL	STEEL
M4	2.7	2.6
M5	5.5	5.1
M6	9.7	8.7
M8	23.0	21.2
M10	47.0	42.0
M12	80.0	73.0

10	Proteção Motor / Engine Protection	Nº123	1
9	Veio Aço / Came Steel	ZN (X2)M8x25/Ø10x200mm - HVI0010002	1
8	Casquilho Alumínio / Aluminum Bushing	Ø20xØ9x10mm - HCQ01A0054	2
7	Casquilho Alumínio / Aluminum Bushing	Ø16xØ10x83,5mm - HCQ01A0154	1
6	Fixação Inox / Stainless Steel Clamp	C123	1
5	Fixação Inox / Stainless Steel Clamp	B123	1
4	Fixação Inox / Stainless Steel Clamp	A123	1
3	Mola de Friso / Stainless Steel Clip	M6	6
2	Parafuso / Screw	M8x30 DIN6921 A2	2
1	Parafuso com Falsa Anilha / Screw with Washer False	M6x16 FA ISO7380 A2	6
ITEM Nº:	COMPONENTE (COMPONENT):	DESCRIÇÃO (DESCRIPTION):	QUANT.:
ACESSÓRIOS (ACCESSORIES)			

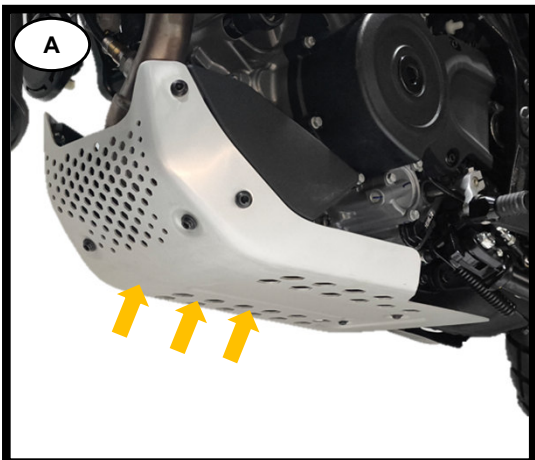

English:

- Remove OEM protection.

Français:

- Retirer la protection OEM.

Português:

- Remover a proteção OEM.

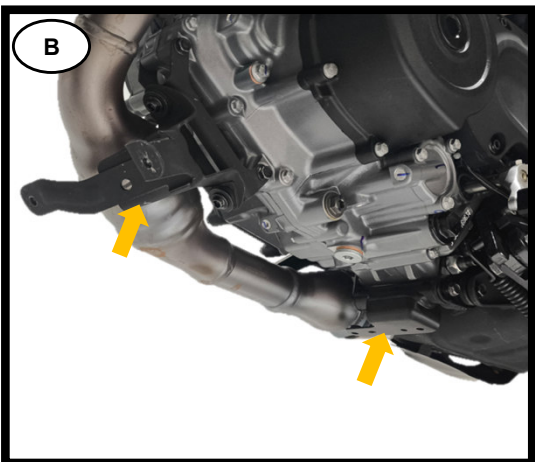

English:

- Remove OEM clamps (x2) marked in the photo.

Français:

- Retirez fixations OEM (x2) marquées sur la photo.

Português:

- Remover fixações OEM (x2) marcadas na foto.

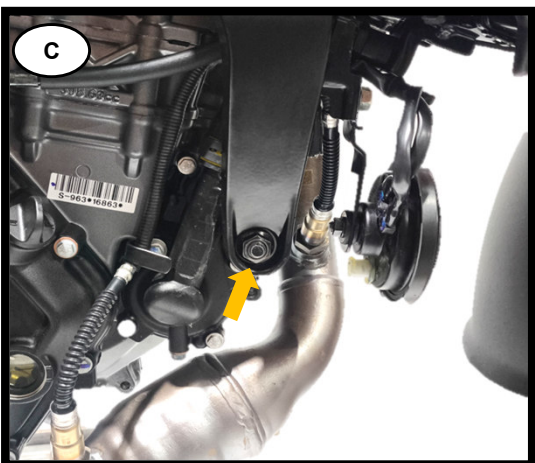

English:

- Remove the nut marked in the photo.
- ▶ **ATTENTION:** place the tool on the left side for assistance.

Français:

- Retirez l'écrou marquées sur la photo.
- ▶ **ATTENTION:** placez l'outil sur le côté gauche pour vous aider.

Português:

- Remover porca marcada na foto.
- ▶ **ATENÇÃO:** colocar ferramenta do lado esquerdo para ajudar.

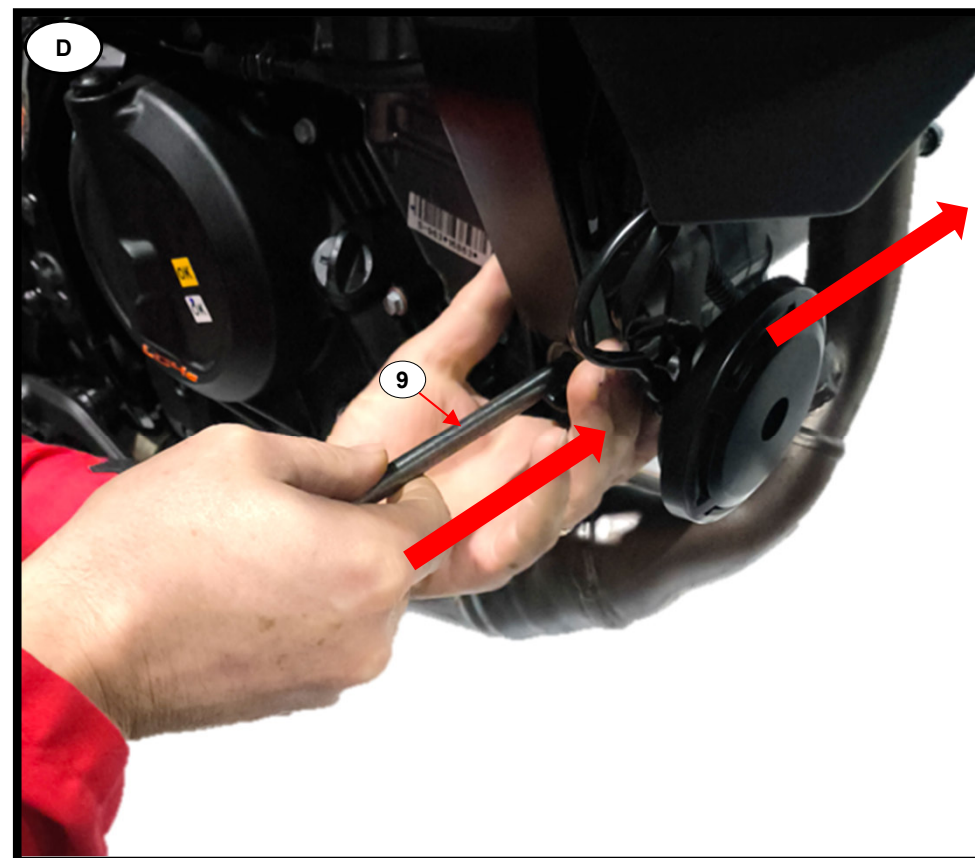

English:

- Apply item N°9 (Bushing) to push in the OEM screw.
- ▶ **ATTENTION:** keep the OEM bushings between the frame and the engine.

Français:

- Appliquer l'item N°9 (Bague) pour insérer le vis OEM.
- ▶ **ATTENTION:** conservez les bagues OEM entre le cadre et le moteur.

Português:

- Aplicar o item N°9 (Veio) para empurrar parafuso OEM.
- ▶ **ATENÇÃO:** manter os casquilhos OEM entre o quadro e o motor.