



English:

- Position and drill using a Ø9 drill bit.

Français:

- Positionnez et percez à l'aide d'un foret de Ø9.

Português:

- Posicionar e furar com uma broca Ø9.



English:

- Position and drill using a Ø9 drill bit.

Français:

- Positionnez et percez à l'aide d'un foret de Ø9.

Português:

- Posicionar e furar com uma broca Ø9.



English:

- Apply the items according to the photo.

► **ATTENTION:** put glue on all the screws.

Français:

- Appliquez les items conformément à la photo.

► **ATTENTION:** mettez de la colle sur toutes les vis.

Português:

- Aplicar os itens de acordo com a foto.

► **ATENÇÃO:** Aplicar cola em todos os parafusos.

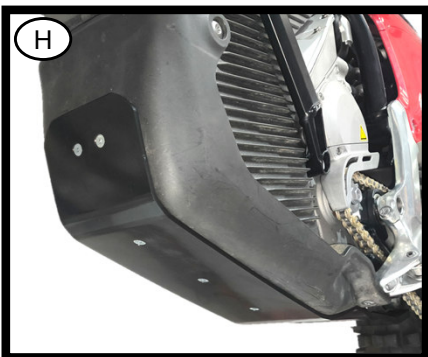

English:

- Mount protection with OEM screws.

Français:

- Monter la protection avec les vis OEM.

Português:

- Montar a proteção com parafusos OEM.

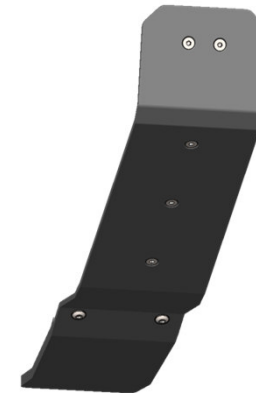

MX DTC ENGINE GUARD

Ref.: 2AS0790245



Assembly Booklet / Paper collection

Livret de montage / Collecte de papier



Mini Zip Bag / Plastic collection

Mini sac zip / Collecte de plastique



Box / Paper collection

Boîte / Collecte de papier



Carton Separator / Paper collection

Séparateur de cartons / Collecte de papier



Card Header / Paper collection

Carte d'en-tête / Collecte de papier



Plastic Bag Cover / Plastic collection

Couverte de sac en plastique / Collecte de plastique



ASSEMBLY SEQUENCE / INSTRUÇÃO DE MONTAGEM

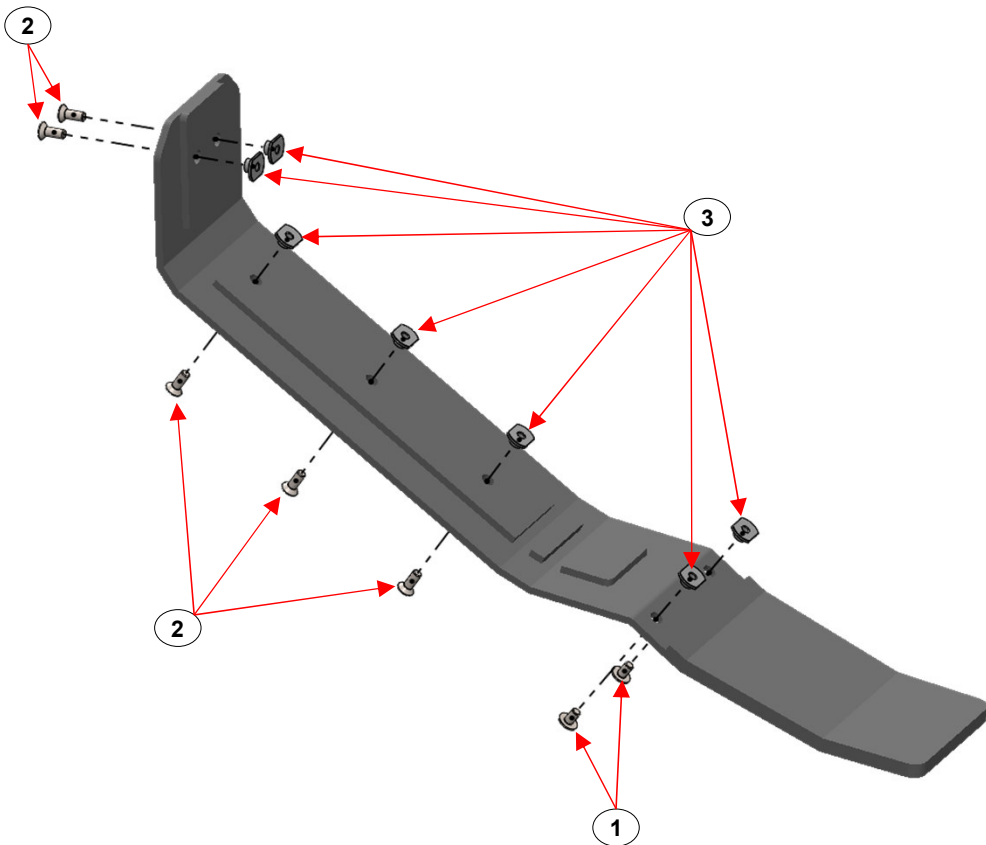

	N.m	M4	M5	M6	M8	M10	M12
		STEEL	8.8	2.7	5.5	9.7	23.0
STAINLESS STEEL	A2	2.6	5.1	8.7	21.2	42.0	73.0

4	Folha de Instruções / Instruction Sheet	2000790245	1
3	Casquilho Alumínio / Aluminum Bushing	Ø20x8 RPØ9x6/FC15mm M6 - HCQ01A0160	7
2	Parafuso / Screw	M6x16 DIN7991 8.8	5
1	Parafuso com FA / Screw with Washer False	M6x10 FA ISO7380 8.8	2
ITEM Nº:	COMPONENTE (COMPONENT):	DESCRIÇÃO (DESCRIPTION):	QUANT.:
ACESSÓRIOS (ACCESSORIES)			

MX DTC ENGINE GUARD



English:

- Remove the outer motor guard and mark the center line as shown in the photo.

Français:

- Retirez la protection extérieure du moteur et marquez la ligne centrale comme indiqué sur la photo.

Português:

- Remover proteção exterior de motor e marcar a linha centro como na foto.

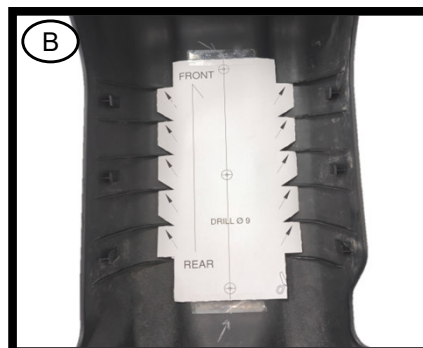

English:

- Cut out the attached sheet and position it on the protective cover. Use adhesive tape to help with positioning.

Français:

- Découpez la feuille jointe et positionnez-la sur la couverture de protection. Utilisez du ruban adhésif pour faciliter le positionnement.

Português:

- Cortar a folha em anexo e posicionar na proteção. Colar com fita cola para ajudar no posicionamento.

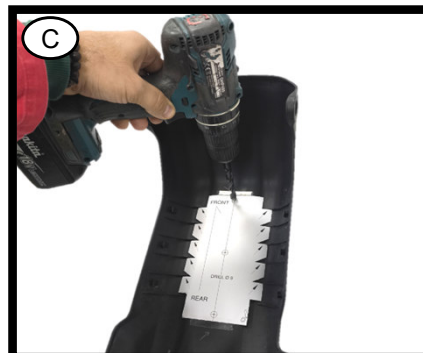

English:

- Drill with a Ø9 drill bit in the indicated locations (x3).

Français:

- Percez avec un foret de Ø9 aux emplacements indiqués (x3).

Português:

- Furar com uma broca Ø9 nos sítios indicados (x3).

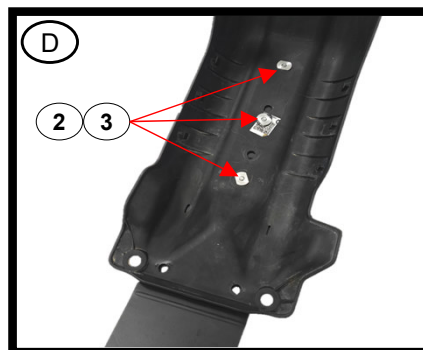

English:

- Apply item N°2 (Screw – x3) and N°3 (Aluminum Bushing – x3) show in the photo.

Français:

- Appliquer les items N°2 (Vis – x3) et N°3 (Bague Aluminium – x3) comme indique sur la photo.

Português:

- Aplicar os itens N°2 (Parafuso – x3) e N°3 (Casquilho Alumínio – x3) como indicado na foto.